



Industrial & Commercial LED Lighting Company

4403 Greenbriar Dr, Stafford, Texas 77477  
 Tel No. 1-800-8385070  
 Monday - Friday 8:30 AM to 5:30 PM

## 344 SERIES T8 LED TUBE



### Product Features:

- 344 Series T8 LED Tube dual function VIA'lich can work with specific ballast and is an energy-saving product as a unique replacement for traditional fluorescent TS lamps.
- 3 in 1: Ballast compatible, single-ended ballast bypass, double-ended ballast bypass
- Current leakage protection: passed UL 1993 new standard.
- Safety: Constant current, and constant power when working with HO ballast without any Arc Discharge
- Easy for stocking can save 66.66% stock space
- Reduces energy consumption by up to 60%.
- Shatterproof design: meets NSF requirements Automatic production, high product consistency
- Lifespan:50,000hrs

### NOTE:

- No need to consider one end power input or two ends power input.
- No need to consider AC power input or with electronic ballast!

## Product Specification

Model	Voltage (V)	Power (W)	Lumen (B)	Lumen efficiency (B)	CRI (Ra)	PF	Colour temperature (K)	Housing Material	LED type	THD	Beam angle(°)
334D2-18W T84*TypeA+B	AC120-277V 50/60Hz	18W	2520lm	140lm/W	83	0.9	4000K / 5000K	Glass Coaling	100PCS SMD2835	<20%	32°

DVDLIGHTS - INDUSTRIAL & COMMERCIAL LED LIGHTING COMPANY - 344 SERIES T8 LED TUBE

Photometrics

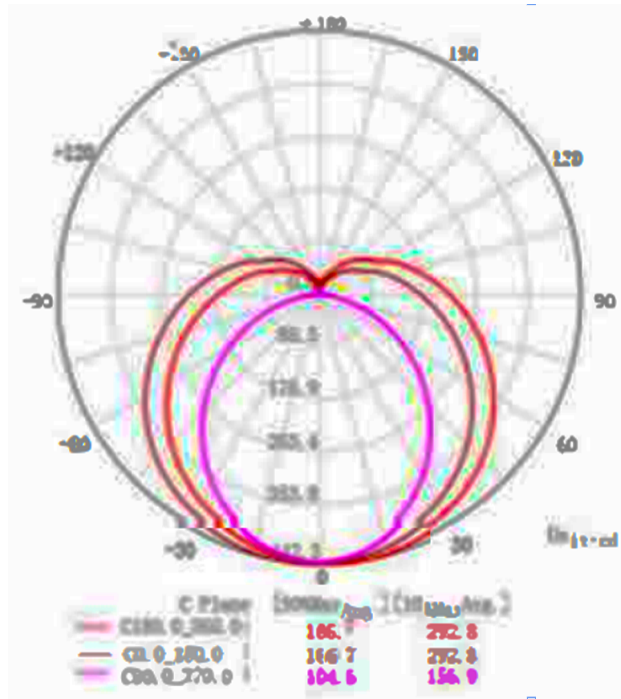

Installation

**TYPE A (Ballast compatible) - Assembly introduction:**



**Type A Installation Guide:**

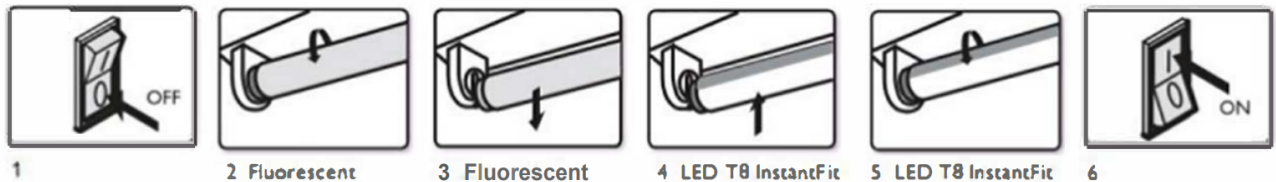

**TYPE B (AC directly, Single end and double end ballast bypass) - Assembly introduction:**

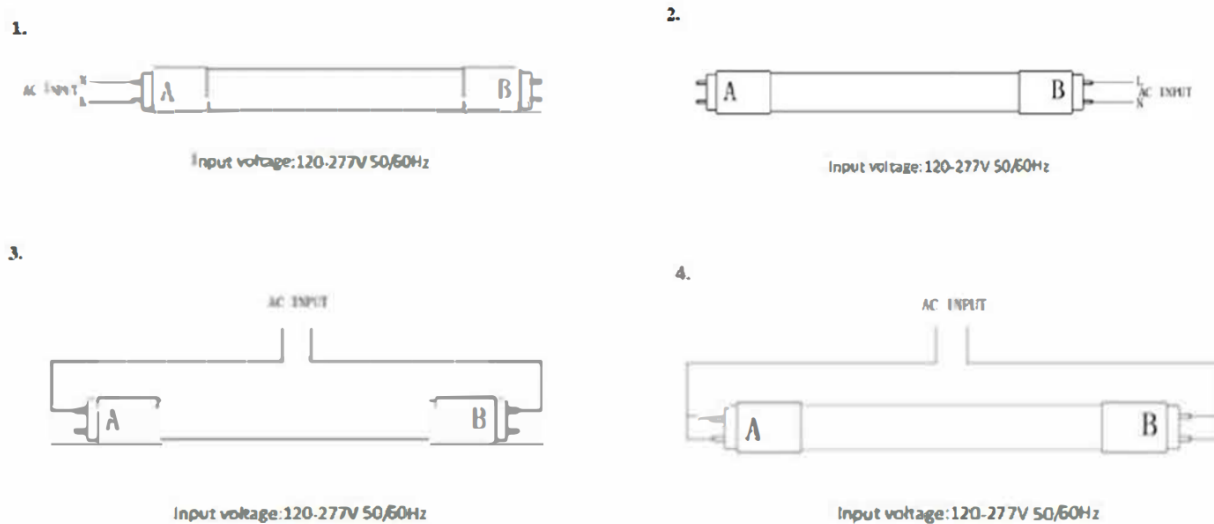

DVDLIGHTS - INDUSTRIAL & COMMERCIAL LED LIGHTING COMPANY - 344 SERIES T8 LED TUBE