



Industrial & Commercial LED Lighting Company

4403 Greenbriar Dr, Stafford, Texas 77477
 Tel No. 1-800-8385070
 Monday - Friday 8:30 AM to 5:30 PM

334 SERIES T8 LED TUBE



Product Features:

- 334 Series T8 LED Tube dual function VIA'lich can work with specific ballast and is an energy-saving product as a unique replacement for traditional fluorescent TS lamps.
- 3 in 1: Ballast compatible, single-ended ballast bypass, double-ended ballast bypass
- Current leakage protection: passed UL 1993 new standard.
- Safety: Constant current, and constant power when working with HO ballast without any Arc Discharge
- Easy for stocking can save 66.66% stock space
- Reduces energy consumption by up to 60%.
- Shatterproof design: meets NSF requirements Automatic production, high product consistency
- Lifespan:50,000hrs

NOTE:

- No need to consider one end power input or two ends power input.
- No need to consider AC power input or with electronic ballast!

Product Specification

Model	Voltage (V)	Power (W)	Lumen (B)	Lumen efficiency (B)	CRI (Ra)	PF	Colour temperature (K)	Housing Material	LED type	THD	Beam angle(°)
334D2-18W T84'TypeA+B	AC120-277V 50/60Hz	18W	2520lm	140lm/W	83	0.9	4000K / 5000K	Glass Coaling	100PCS SMD2835	<20%	32 0°

DVDLIGHTS - INDUSTRIAL & COMMERCIAL LED LIGHTING COMPANY - 334 SERIES T8 LED TUBE

Photometrics

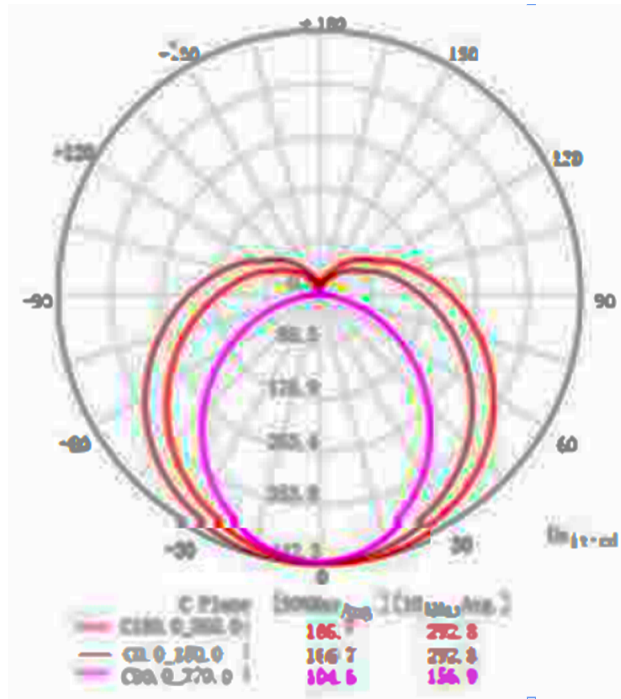

Installation

TYPE A (Ballast compatible) - Assembly introduction:

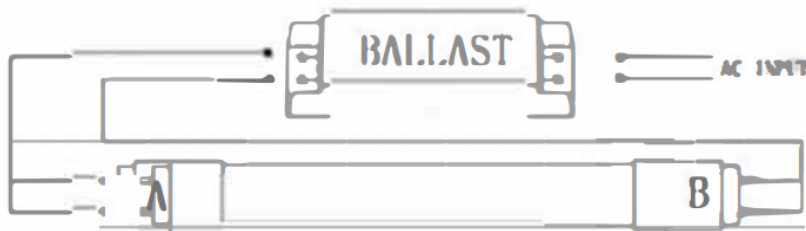

Type A Installation Guide:

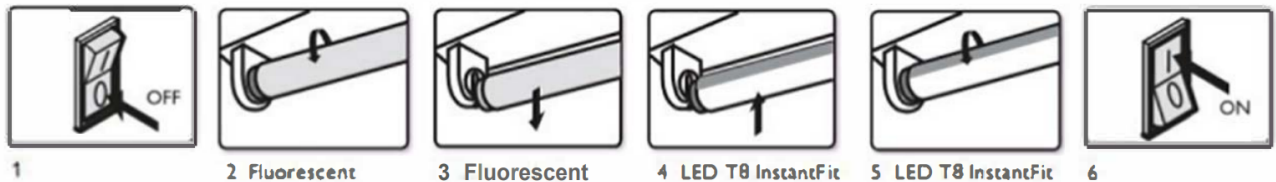

TYPE B (AC directly, Single end and double end ballast bypass) - Assembly introduction:

